

SIGN	DATE	DESCRIPTION	APPROVER
△	2/06'06	Part No. changed	Tony
△	3/10'09	Structure changed	Seamus
△	3/10'09	Dimension changed	Seamus
△	11/03'12	Change the screw plating specification	Jacky
△	11/03'12	Change the dimensional tolerance	Jacky

THIS IS CAD DRAWING, DO NOT REVISE MANUALLY!!!

N=Number of poles
Dimension A&B&C

DIM A	(N+1)×8.25
DIM B	(N-1)×8.25
DIM C	(N+2)×8.25+2.5

Poles	Tolerance
2p-5p	+0.25/-0.25
6p-10p	+0.35/-0.35
11p-18p	+0.40/-0.40
19p-30p	+0.50/-0.50

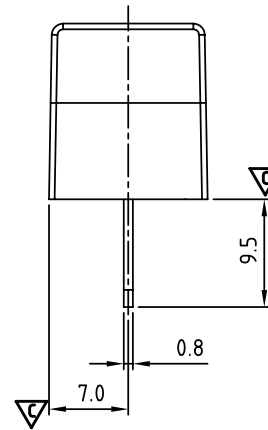
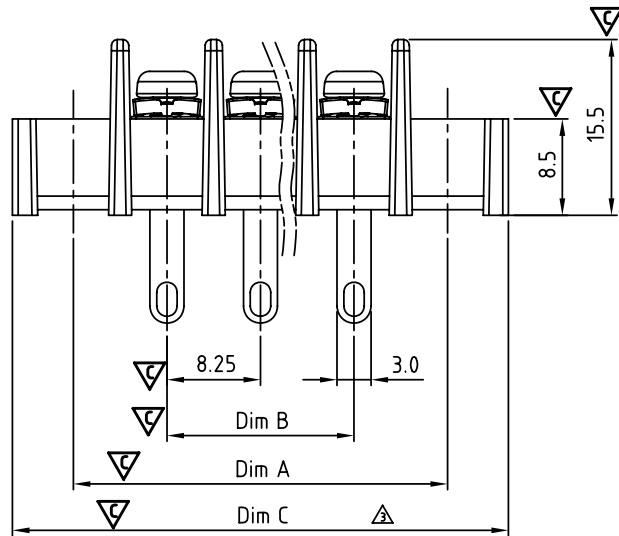
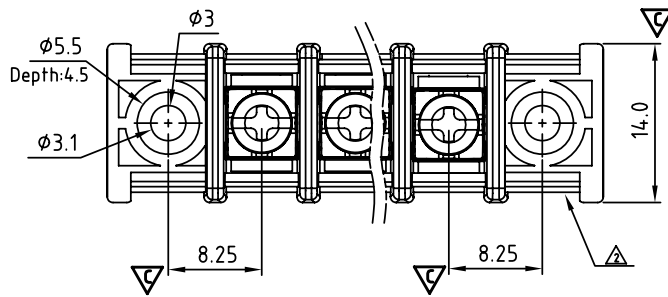

MATERIALS ELECTRICAL

RATED VOLTAGE & CURRENT:

300 V, 20 A

WITHSTAND VOLTAGE:

AC 2000 V/Min

INSULATION RESISTANCE:

1000 MΩ OR MORE AT DC 500 V

OPERATING TEMPERATURE RANG:

-40 °C ~ +115 °C

SCREW TORQUE VALUE:

8.8 Lb-In.

WIRE RANGE:

22 - 12 AWG

1) MOLDED PARTS:

POLYIMIDE 66, UL 94 V-0 BLACK

2) TERMINAL:

BRASS, 0.8t, Tin PLATED

△ 3) TERMINAL SCREWS:

STEEL, M3

APPROVAL:

△ PART NO.:

Critical dimension:

YK 413 xx 3 x x 00G

NO. OF POLES

02: 2 POLES
03: 3 POLES
04: 4 POLES
...

30: 30 POLES

RoHS compliant
(lead<4%) In copper Alloy

MARK

0: "@" MARK
1: "ANY" MARK

TERMINAL & SCREW PLATED

0: TERMINAL & SCREW: G/F

△ 1: TERMINAL: G/F, SCREW: Zinc

2: TERMINAL: Sn, SCREW: G/F

△ 3: TERMINAL: Sn, SCREW: Zinc

ANYTEK

CUSTOMER COPY

ALL RIGHTS RESERVED. REPRODUCTION OR ISSUE TO THIRD PARTIES IN ANY FORM WHATSOEVER IS NOT PERMITTED WITHOUT WRITTEN AUTHORITY FROM THE PROPRIETOR. PROPERTY OF ANYTEK TECHNOLOGY CO., LTD

TITLE		YK-413 With Flange Series			DWG NO.		8YK0002-413	
PART NO.		YK413xx3xx00G			DWG NO.		8YK0002-413	
APPROVED	CHECKED	DESIGNED	DRAWN	CUST NO.		Tolerance		
		Jacky 2012.11.03	Jacky 2012.11.03			X. ±0.50		
						UNIT: mm		X.X ±0.30
						SCALE: NONE		X.XX ±0.10
						SHEET: 01/01		X° ±1°
						REV.: E		