

SIGN	DATE	DESCRIPTION	APPROVER
△			
THIS IS CAD DRAWING, DO NOT REVISE MANUALLY!!!			

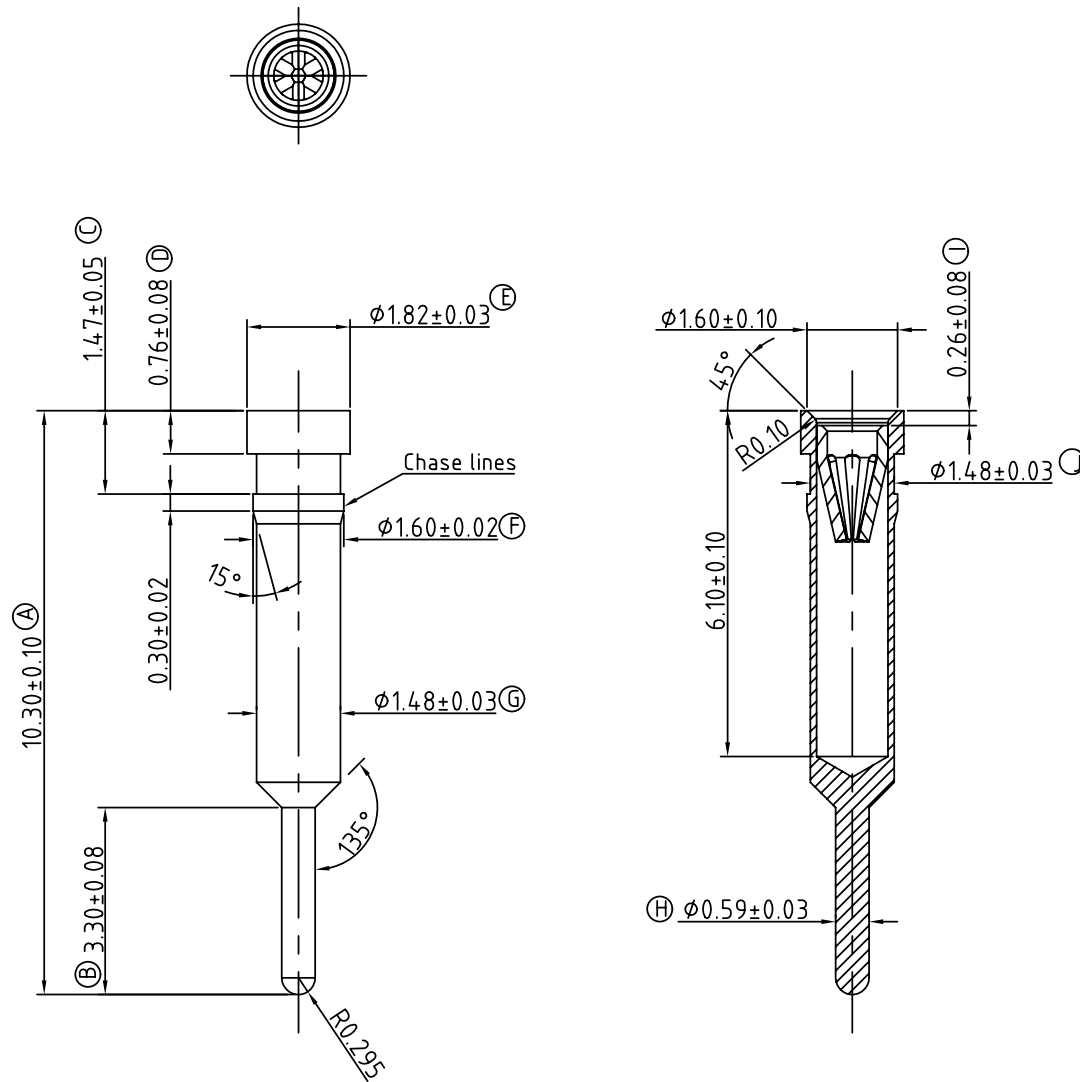

Technical Data:

Material:

- Pin (outer sleeve) : Brass, machined, CuZn38pB2
- Clip (contact 6 finger) : BeCu, heat treated.
- Plating (Outer sleeve) : Tin plated: 2um/80u" nickel, 5um/200u" tin
Gold plated: 2um/80u" nickel, Full gold flash
- Plating (contact) : 2um/80u" nickel, gold or tin plating.

Electrical

- Current rating: 3Amps/contact max
- Contact resistance: $\leq 4m\Omega$ /contact

Mechanical

- Maximum Insertion force with solid pin of $\phi 0.66mm$: 140g
- Minimum Withdrawal force with solid pin of $\phi 0.66mm$: 25g

OJ X 0 0 0 X 00000G

Code	Definition	Code	Clip plated	Pin plated
6	6 finger	0	Gold flash	Tin 200u"
		1	Gold 10u"	Tin 200u"
		2	Gold 30u"	Tin 200u"
		3	Tin 200u"	Tin 200u"
		4	Gold flash	Gold flash
		5	Gold 10u"	Gold flash
		6	Gold 30u"	Gold flash

ANYTEK

INSPECTION COPY

ALL RIGHTS RESERVED. REPRODUCTION OR ISSUE TO THIRD PARTIES IN ANY FORM WHATSOEVER IS NOT PERMITTED WITHOUT WRITTEN AUTHORITY FROM THE PROPRIETOR. PROPERTY OF ANYTEK TECHNOLOGY CO., LTD

TITLE		OJ 10.3mmL Pin(Chase lines).			
PART NO.		OJX 0 0 0 X 00000G		DWG NO. OJ0001	
APPROVED	CHECKED	DESIGNED	DRAWN	CUST NO.	
		Seamus 2008.06.04	Aaron 2004.11.20		
				Tolerance	
				X. ±0.50	
				X.X ±0.30	
				X.XX ±0.10	
				X° ±1°	
				UNIT: mm	
				SCALE: NONE	
				SHEET: 01/01	
				REV.: A	