

SIGN	DATE	DESCRIPTION	APPROVER
△			
THIS IS CAD DRAWING, DO NOT REVISE MANUALLY!!!			

Material:

- Pin (outer sleeve): Brass, machined, CuZn38pB2
- Clip (contact 6 finger): Beryllium copper, heat treated
- Plating (outer sleeve): Tin plated: 2um/80u"
Nickel, 5um/200u" Tin;
Gold plated; 5um/200u" nickel;
Full gold flash.

(contact): 2um/80u" Nickel, gold or Tin plating

- Contact resistance per contact : <math><4m\Omega</math>
- Insulation resistance : 10000M Ω at 500VAC

Mechanical

- Average insertion force with steel pin of $\Phi 0.38\text{mm}/.015''$: 60g
- Average withdrawal force with steel pin of $\Phi 0.38\text{mm}/.015''$: 15g
- Mechanical life cycle : 200 time / minimum

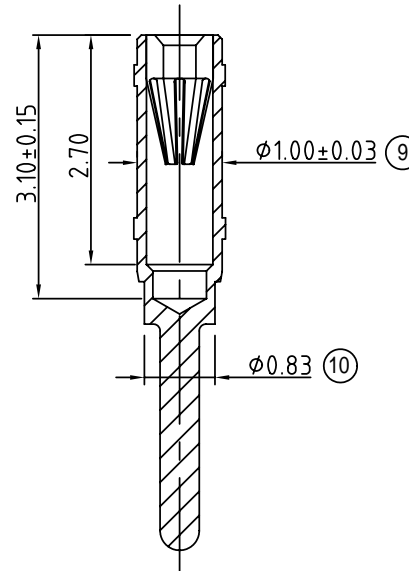
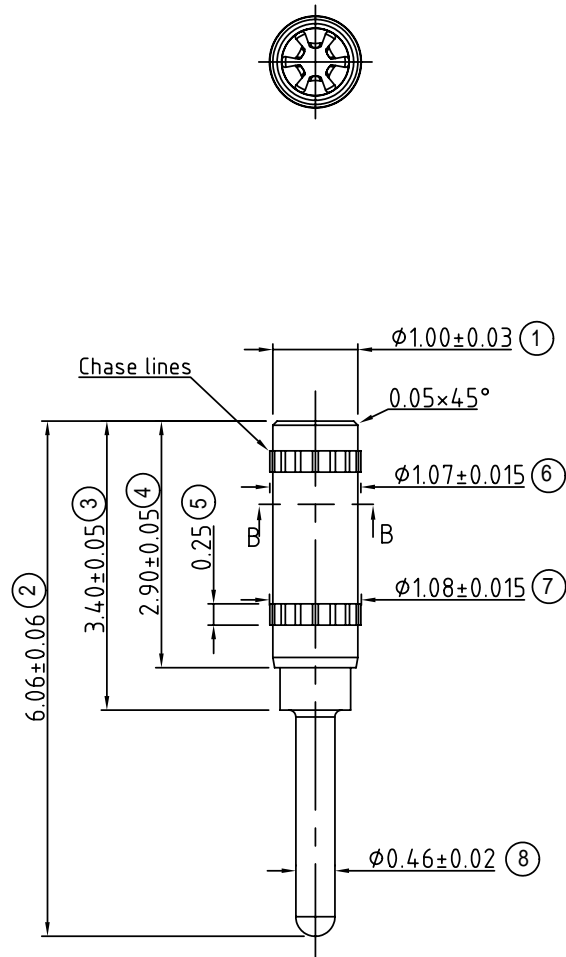

04 - 6 0 0 0 X 0 0000G

pin plated: Code	Clip plated	Pin plated
0	Gold Flash	Tin 200u"
1	Gold 10u"	Tin 200u"
2	Gold 30u"	Tin 200u"
3	Tin 200u"	Tin 200u"
4	Gold flash	Gold flash
5	Gold 10u"	Gold flash
6	Gold 30u"	Gold flash

ANYTEK

CUSTOMER COPY

ALL RIGHTS RESERVED. REPRODUCTION OR ISSUE TO THIRD PARTIES IN ANY FORM WHATSOEVER IS NOT PERMITTED WITHOUT WRITTEN AUTHORITY FROM THE PROPRIETOR. PROPERTY OF ANYTEK TECHNOLOGY CO., LTD

TITLE		04 6.06mmL Pin(Chase lines) finished products				
PART NO.		046000X00000G		DWG NO.		8040001
APPROVED	CHECKED	DESIGNED	DRAWN	CUST NO.		Tolerance
		Seamus 2006.04.22	Aaron 2006.04.20			X. ±0.50
				UNIT: mm		X.X ±0.30
				SCALE: NONE		X.XX ±0.10
				SHEET: 01/01		X° ±1°
				REV.: B		