

SIGN	DATE	DESCRIPTION	APPROVER
△			
<i>THIS IS CAD DRAWING, DO NOT REVISE MANUALLY!!!</i>			

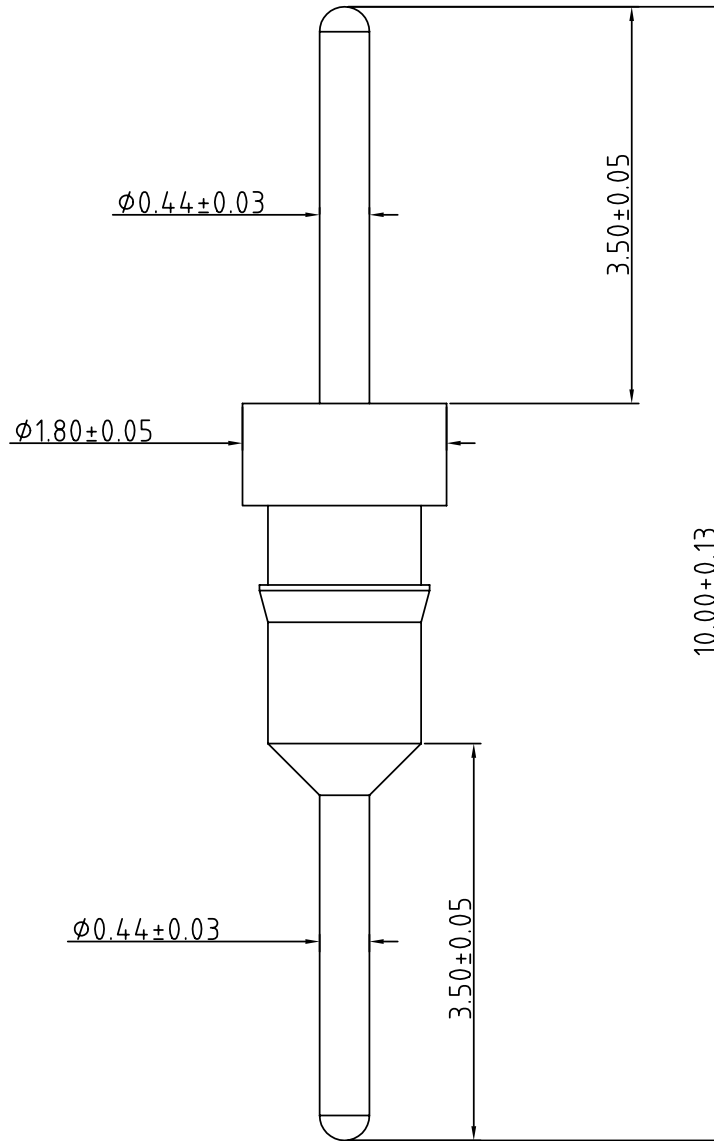

**Technical Data**

- ◆ Material:
  - Pin (outer sleeve): Brass, machined, CuZn38Pb2
  - Plating: Tin plated: 2um/80u"nickel, 5um/200u"Tin  
Gold plated: 2um/80 u"nickel, full gold
- ◆ Electrical
  - Current rating: 3 Amps/contact max.
  - Insulation resistance:  $\geq 10000 \text{ MWat } 500 \text{ VAC}$
  - Rated voltage: 100 VRMS /150VDC

**ANYTEK**

**INSPECTION COPY**

ALL RIGHTS RESERVED. REPRODUCTION OR ISSUE TO THIRD PARTIES IN ANY FORM WHATSOEVER IS NOT PERMITTED WITHOUT WRITTEN AUTHORITY FROM THE PROPRIETOR. PROPERTY OF ANYTEK TECHNOLOGY CO., LTD

TITLE	ON mm Pin Sleeve				DWG NO.		ON0004	
PART NO.	ON0000x00000G			CUST NO.				
APPROVED	CHECKED	DESIGNED	DRAWN	Tolerance				
		Seamus 2006.07.28	Aaron 2006.07.28		UNIT: in	X.	±0.50	
					SCALE: NONE	X.X	±0.30	
				SHEET: 01/01	REV.: A	X.XX	±0.10	
						X*	±1°	