

SIGN	DATE	DESCRIPTION	APPROVER
△			
THIS IS CAD DRAWING, DO NOT REVISE MANUALLY!!!			

**Technical Data**

- ◆ **Material:**
  - Pin (outer sleeve) : Brass,machined, CuZn38Pb2
  - Clip(contact 4 finger) : Beryllium copper ,heat treated or PHBZ
  - Plating(outer sleeve) : Tin plated : 2um/80u"nickel,5um/200u"Tin  
Gold plated: 2um/80u"nickel,full gold
  - Plating clip(contact): 2um/80 u"nickel,gold or tin plating
  - Insulator body(black) : Glass filled Hi-temperature thermoplastic UL94V-0
- ◆ **Electrical**
  - Current rating : 3 Amps/contact max.
  - Contact resistance :  $\leq 4m\Omega$ /contact
  - Insulation resistance :  $\geq 10000M\Omega$ at 500VAC
  - Rated voltage : 100 VRMS /150VDC
- ◆ **Mechanical**
  - Operating temperature : Gold plated:-55°C to +105°C  
(Continuous) -67°F to +105°F  
Tin plated:-40°Cto +105°C
  - Average insertion force with steel pin of:  $\phi 0.43mm/0.017"$  < 250g
  - Average withdrawal force with steel pin of $\phi 0.43mm/0.017"$  >50g
  - Mechanical life : min.200
- ◆ **Applications and features:**
  - 1.The open frame is most common type.
  - 2.The open body design gives better access (for cleaning and inspections) to air -cooling.
  - 3.Side and end stackable.
  - 4.High retention design prevents IC walkout during heavy vibration.
  - 5.Closed bottom sleeve for 100% anti-wicking of silder.
  - 6.Twist free construction.

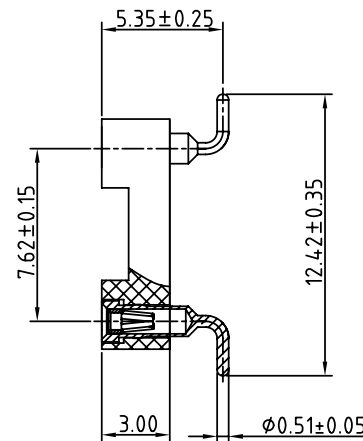
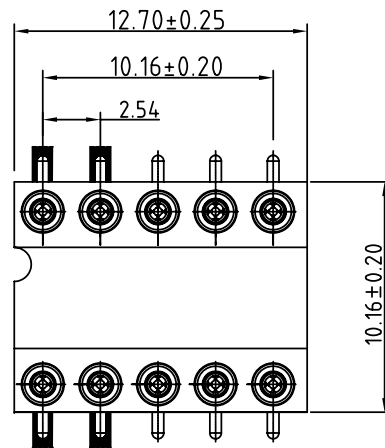

SE - 10 3 1 X 20100G

	pin plated: Code	Clip plated	Pin plated
0	Gold Flash	Tin 200u"	Tin 200u"
1	Gold 10u"	Tin 200u"	Tin 200u"
2	Gold 30u"	Tin 200u"	Tin 200u"
3	Tin 200u"	Tin 200u"	Tin 200u"
4	Gold flash	Gold flash	Gold flash
5	Gold 10u"	Gold flash	Gold flash
6	Gold 30u"	Gold flash	Gold flash

**ANYTEK**

**CUSTOMER COPY**

ALL RIGHTS RESERVED. REPRODUCTION OR ISSUE TO THIRD PARTIES IN ANY FORM WHATSOEVER IS NOT PERMITTED WITHOUT WRITTEN AUTHORITY FROM THE PROPRIETOR. PROPERTY OF ANYTEK TECHNOLOGY CO., LTD

TITLE	SE折彎90°IC Socket 0.3型系列圖 (ROHS).(close frame)				DWG NO.		8SE0009	
PART NO.	SE1031X20100G				CUST NO.			
APPROVED	CHECKED	DESIGNED	DRAWN	Tolerance				
		Seamus 2005.07.12	Aaron 2004.11.20	X. ±0.50		X.X ±0.30		
				X.XX ±0.10		X* ±1*		
				SHEET: 01/01		REV.: B		