

SIGN	DATE	DESCRIPTION	APPROVER
△			

THIS IS CAD DRAWING, DO NOT REVISE MANUALLY!!!

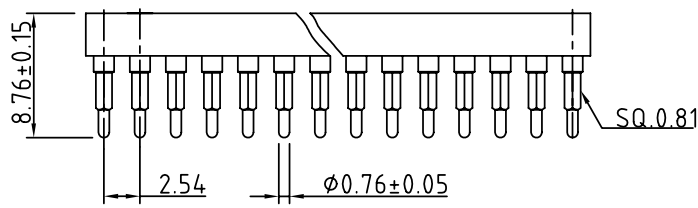

P.C.B. LAYOUT

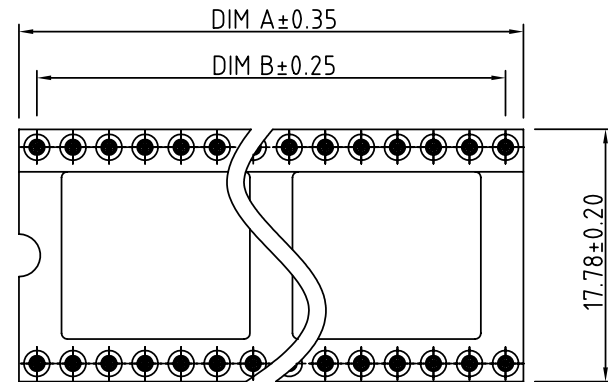
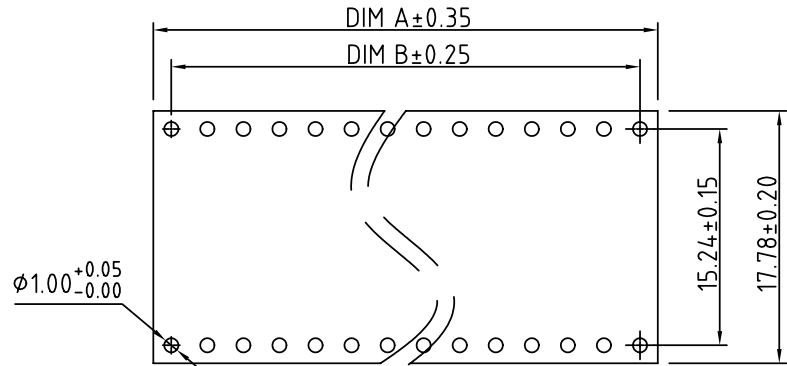
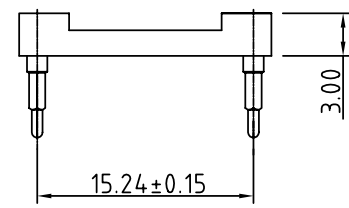

Technical Data:

Material:

- Pin (outer sleeve) : Brass,machined, CuZn38Pb2
- Clip(contact 4 finger):Beryllium copper,heat treated
- Plating(outer sleeve) : Tin plated:2μm/80μ"nickel,5μm/200μ"Tin  
Gold plated:2μm/80μ"nickel,Full gold
- Plating(contact):2μm/80μ"nickel,gold or Tin plating
- Insulator body(housing) : PBT(UL94V-0)

Electrical

- Current rating : 3 Amps/contact max.
- Contact resistance : <4mΩ/contact
- Insulation resistance: >10000MΩ at V=500V
- Operating : 60 vac/DC

Mechanical

- Operating temperature: Gold plated:-55°C to +125°C (continuous) Tin plated:-40°C to +105°C
- Average insertion force : <250g with steel pin of φ0.43mm/0.017"
- Average withdrawal :>50g force with steel pin of φ0.43mm/0.017"
- Mechanical life : min.200
- Soldering temperture : +260°C,10s max.

SC - XX 6 0 X 1 0000G

No.of contacts :24-52

pin plated: Code	Clip plated	Pin plated
0	Gold Flash	Tin 200u"
1	Gold 10u"	Tin 200u"
2	Gold 30u"	Tin 200u"
3	Tin 200u"	Tin 200u"
4	Gold flash	Gold flash
5	Gold 10u"	Gold flash
6	Gold 30u"	Gold flash

Contact	DIM A	DIM B	Contact	DIM A	DIM B
24	30.48	27.94	42	53.34	50.80
28	35.56	33.02	48	60.96	58.42
32	40.64	38.10	50	63.50	60.96
36	45.72	43.18	52	66.04	63.50
40	50.80	48.26			

<b>ANYTEK</b>				<b>CUSTOMER COPY</b>															
<small>ALL RIGHTS RESERVED. REPRODUCTION OR ISSUE TO THRD PARTIES IN ANY FORM WHATSOEVER IS NOT PERMITTED WITHOUT WRITTEN AUTHORITY FROM THE PROPRIETOR. PROPERTY OF ANYTEK TECHNOLOGY CO., LTD</small>																			
TITLE	SC-IC Sockets 8.76mmL PIN (0.6") Series																		
PART NO.	SCXX60X10000G			DWG NO.	8SC0601														
APPROVED	CHECKED	DESIGNED	DRAWN	CUST NO.	Tolerance														
		Seamus 2006.01.14	Aaron 2006.01.10		<table border="1"> <tr> <td>UNIT: mm</td> <td>X.</td> <td>±0.50</td> </tr> <tr> <td>SCALE: NONE</td> <td>X.X</td> <td>±0.30</td> </tr> <tr> <td></td> <td>X.XX</td> <td>±0.10</td> </tr> <tr> <td></td> <td>X*</td> <td>±1°</td> </tr> </table>			UNIT: mm	X.	±0.50	SCALE: NONE	X.X	±0.30		X.XX	±0.10		X*	±1°
UNIT: mm	X.	±0.50																	
SCALE: NONE	X.X	±0.30																	
	X.XX	±0.10																	
	X*	±1°																	
				SHEET: 01/01	REV.: B														