

SIGN	DATE	DESCRIPTION	APPROVER
△	05/20.08	螺絲孔和螺絲進行變更	Aaron
△	05/20.08	增加cULus	Aaron

THIS IS CAD DRAWING, DO NOT REVISE MANUALLY!!!

Material

- Item① Terminal cover :Thermoplastic (UL94V-0)
- Item② Terminal housing : Thermoplastic (UL94V-0)
- Item③ Terminal screw : Steel Zinc plating "-" slot type
- Item④ Wire guard solder pin : Brass, Tin plated
- Item⑤ Clamp : Steel stamping, Zinc plating

Electrical cULus

- Voltage rating: 300VAC
- Current rating: 10A
- Wire range:
- Solid wire(AWG): 12-22
- Stranded wire(AWG): 12-22
- Torque(Lb-In): 3.5
- Screw: M2.5
- Wire strip length: 6-7mm
- Withstanding Voltage: 1.6KV
- Operating temperature: -40°C to +115°C
- Soldering temperature: 250°C±10°C/5 Sec
- Safety Approval: US

PART NO.

EQ xx 05 x 0 xxxx G

<p>Poles</p> <p>02 2Contacts</p> <p>03 3Contacts</p> <p>.....</p> <p>24 24Contacts</p>	<p>Color</p> <p>0 Black</p> <p>5 Green</p> <p>(RAL 6018/T)</p> <p>6 Blue</p> <p>8 Grey</p> <p>(RAL 7035/D)</p>	<p>RoHS</p> <p>Pb<4,0,000ppm</p> <p>0000 Standard @ Logo</p> <p>000A Standard ANY Logo</p> <p>Any special item by customer request, please contact sales department.</p>
--	--	---

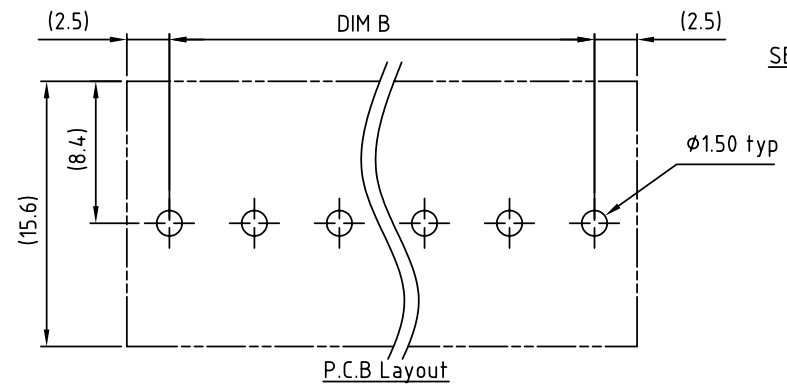
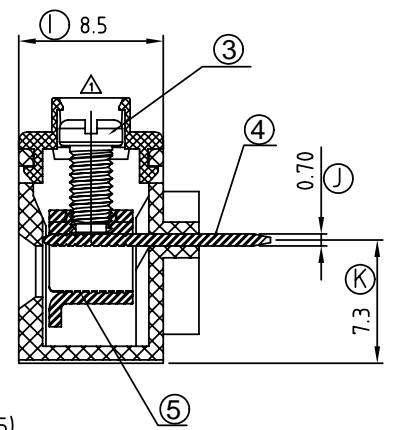
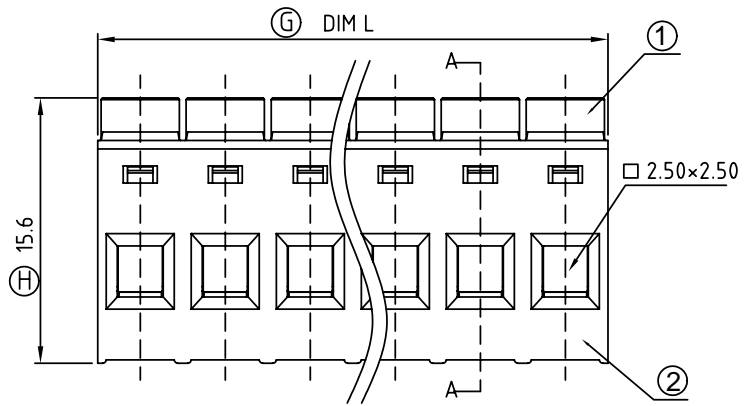
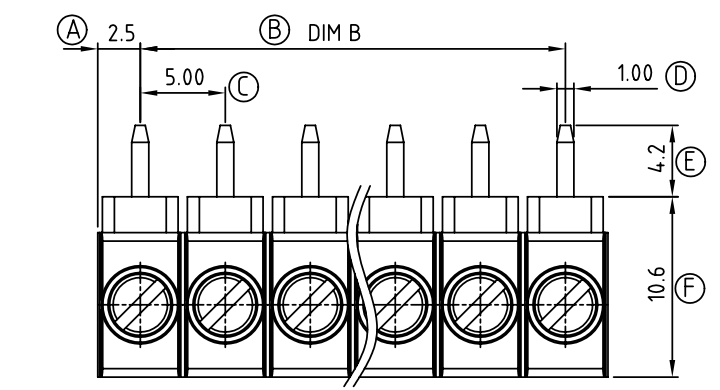

Poles	02	03	04	05	06	07	08	09	10	11	12	13
Dim L	10.00	15.00	20.00	25.00	30.00	35.00	40.00	45.00	50.00	55.00	60.00	65.00
Dim B	5.00	10.00	15.00	20.00	25.00	30.00	35.00	40.00	45.00	50.00	55.00	60.00
TOL	±0.15			±0.20						±0.25		
Poles	14	15	16	17	18	19	20	21	22	23	24	
Dim L	70.00	75.00	80.00	85.00	90.00	95.00	100.0	105.0	110.0	115.0	120.0	
Dim B	65.00	70.00	75.00	80.00	85.00	90.00	95.00	100.0	105.0	110.0	115.0	
TOL	±0.25			±0.30								

ANYTEK				CUSTOMER COPY			
ALL RIGHTS RESERVED. REPRODUCTION OR ISSUE TO THIRD PARTIES IN ANY FORM WHATSOEVER IS NOT PERMITTED WITHOUT WRITTEN AUTHORITY FROM THE PROPRIETOR. PROPERTY OF ANYTEK TECHNOLOGY CO., LTD							
TITLE		EQ 5.0 Series 90 D Wire inlet (Vertical)					
PART NO.		EQxx05x0xxxxG			DWG NO.		8EQ0003
APPROVED		CHECKED	DESIGNED	DRAWN	CUST NO.		Tolerance
			Aaron	Aaron			X. ±0.50
			2008.05.20	2008.05.20			X.X ±0.30
							X.XX ±0.10
					SHEET: 01/01		X* ±1*
					UNIT: mm		
					SCALE: NONE		
					REV.: C		