

SIGN	DATE	DESCRIPTION	APPROVER
△	02/18'06	Part No. is changed	Aaron
THIS IS CAD DRAWING, DO NOT REVISE MANUALLY!!!			

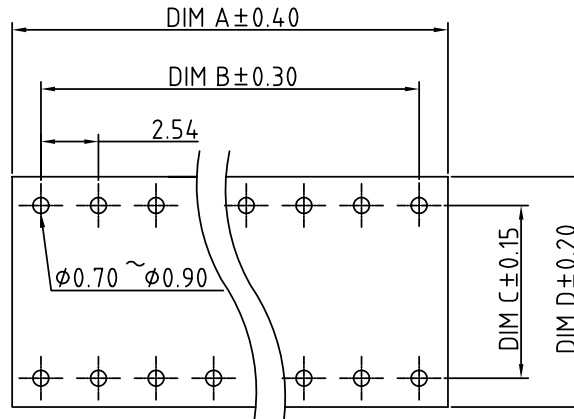

P.C.B. LAYOUT

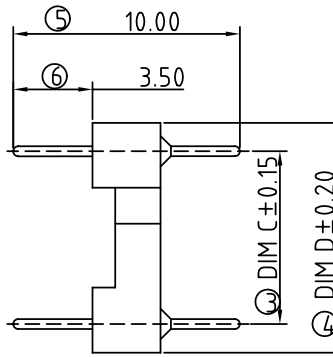
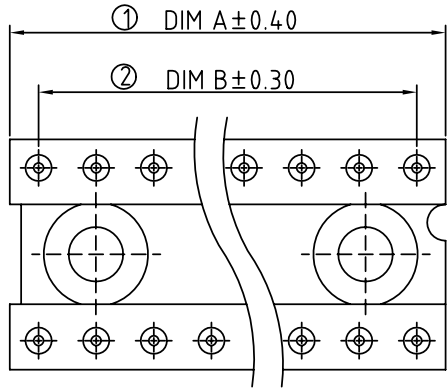
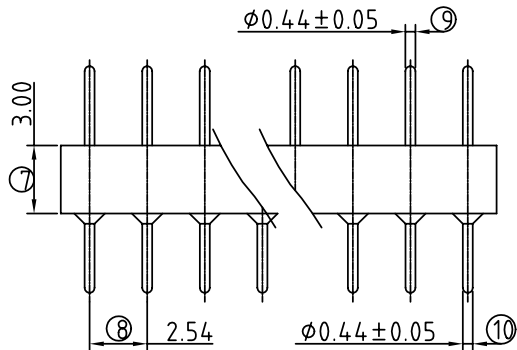

SB Series
Technical Data

- ◆ Material:
 - Pin (outer sleeve) : Brass,machined, CuZn38Pb2
 - Plating : Tin plated : 2um/80u"nickel,5um/200u"Tin
 - Gold plated: 2um/80 u"nickel,full gold
 - Glass filled polyester UL94V-0
- ◆ Insulator body(black) : Glass filled polyester UL94V-0
- ◆ Electrical
 - Current rating : 3 Amps/contact max.
 - Insulation resistance : ≥10000MΩat 500VAC
 - Rated voltage : 100 VRMS /150VDC
- ◆ Mechanical
 - Operating temperature : Gold plated: -550° to +125°
 - (Continuous) -67° F to +257° F
 - Tin plated: -40° to +105°
- ◆ Applications and features:
 - 1.The male header contacts are designed for "Sandwich application" because The pin of EX0.5mm/0.050" can be plugged into a standard IC-contact.
 - 2.3 different heights are available.
 - 3.Low profile type..
 - 4.Side and end stackable.
 - 5.Twist free construction.
- ◆ Environmental data
 - Solderability (IEC 60068-2-20. Ta) :235° C, 2s
 - Resistance to soldering heat (IEC 60068-2-20. Tb) :
 - Through hole mount components :260° C, 10s

SB - XX X 1 X 0 0 0 0 G △

No.of contacts :14p ~ 42p

Code	Definition	pin plated: Code	Pin plated
3	7.62/.300"	0	Tin 200u"
4	10.16/.400"	1	Gold flash
6	15.24/.600"	2	Gold 10u"
9	22.86/.900"	3	Gold 30u"

P/N	Contact	Dim A	Dim B	Dim C	Dim D
SB1431X0X	14	17.78	15.24	7.62	10.16
SB1631X0X	16	20.32	17.78	7.62	10.16
SB1831X0X	18	22.86	20.32	7.62	10.16
SB2031X0X	20	25.40	22.86	7.62	10.16
SB2431X0X	24	30.48	27.94	7.62	10.16
SB2441X0X	24	30.48	27.94	10.16	12.70
SB2461X0X	24	30.48	27.94	15.24	17.78
SB2861X0X	28	35.56	33.02	15.24	17.78
SB3261X0X	32	40.64	38.10	15.24	17.78
SB3661X0X	36	45.72	43.18	15.24	17.78
SB4061X0X	40	50.80	48.26	15.24	17.78
SB4261X0X	42	53.34	50.80	15.24	17.78

ANYTEK

CUSTOMER COPY

ALL RIGHTS RESERVED. REPRODUCTION OR ISSUE TO THIRD PARTIES IN ANY FORM WHATSOEVER IS NOT PERMITTED WITHOUT WRITTEN AUTHORITY FROM THE PROPRIETOR. PROPERTY OF ANYTEK TECHNOLOGY CO., LTD

TITLE		IC/SKT SB 10.00 mmL finished products series (Closed frame)					
PART NO.		SBXXX1X00000G			DWG NO.		8SB0007
APPROVED	CHECKED	DESIGNED	DRAWN	CUST NO.		Tolerance	
		Aaron	Aaron			UNIT: mm	X. ±0.50
		2006.02.18	2006.02.18			SCALE: NONE	X.X ±0.30
						SHEET: 01/01	REV.: C
							X* ±1*