

SIGN	DATE	DESCRIPTION	APPROVER
△	02/18'06	Part No. is changed	Aaron
<i>THIS IS CAD DRAWING, DO NOT REVISE MANUALLY!!!</i>			

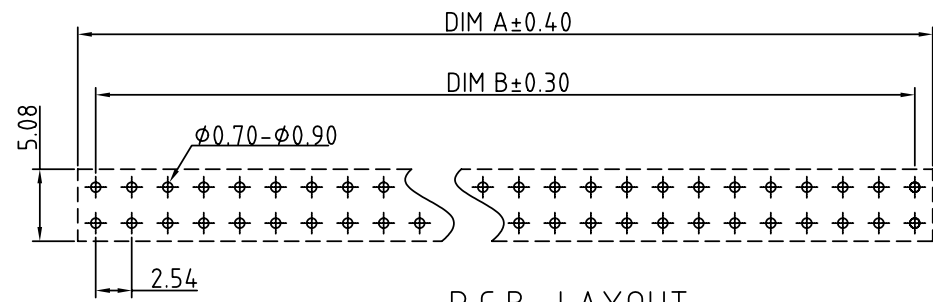
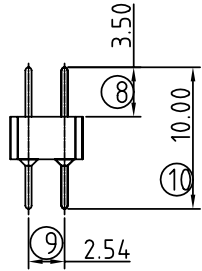
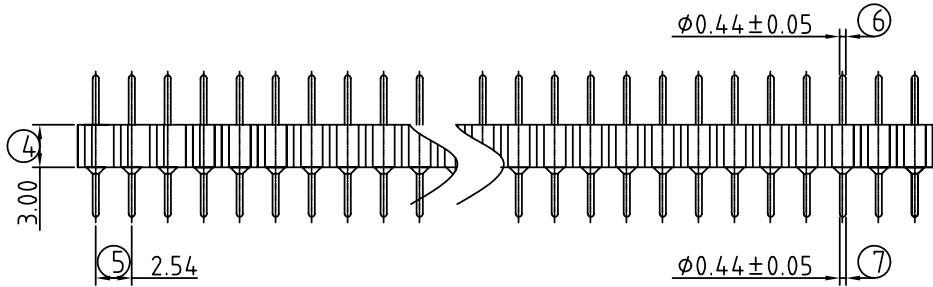
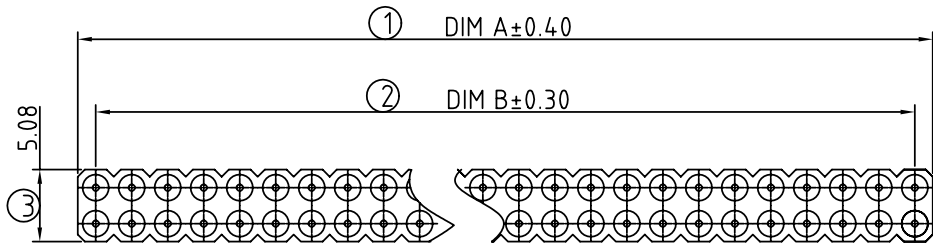

P.C.B. LAYOUT

- SB Series**  
**Technical Data**
- ◆ **Material:**
    - Pin (outer sleeve): Brass, machined, CuZn38Pb2
    - Plating: Tin plated: 2um/80u"nickel, 5um/200u"Tin  
Gold plated: 2um/80 u"nickel, full gold
  - ◆ **Insulator body (black):** Glass filled polyester UL94V-0
  - ◆ **Electrical**
    - Current rating: 3 Amps/contact max.
    - Insulation resistance: ≥10000MΩ at 500VAC
    - Rated voltage: 100 VRMS /150VDC
  - ◆ **Mechanical**
    - Operating temperature: Gold plated: -550°C to +125°C  
(Continuous) -67° F to +257° F
    - Tin plated: -40 °C to +105°C
  - ◆ **Applications and features:**
    1. The male header contacts are designed for "Sandwich application" because The pin of Φ0.5mm/0.050" can be plugged into a standard IC-contact.
    2. 3 different heights are available.
    3. Low profile type..
    4. Side and end stackable.
    5. Twist free construction.
  - ◆ **Environmental data**
    - Solderability (IEC 60068-2-20. Ta): 235° C, 2s
    - Resistance to soldering heat (IEC 60068-2-20. Tb): -Through hole mount components: 260° C, 10s

SB - XX 1 0 X 0 0 0 0 0 G △

No. of contacts : 02p ~ 80p

pin plated: Code      Pin plated

0	Tin 200u"
1	Gold flash
2	Gold 10u"
3	Gold 30u"

Contact	Dim A	Dim B	Contact	Dim A	Dim B	Contact	Dim A	Dim B
02	2.54	—	30	38.10	35.56	58	73.66	71.12
04	5.08	2.54	32	40.64	38.10	60	76.20	73.66
06	7.62	5.08	34	43.18	40.64	62	78.74	76.20
08	10.16	7.62	36	45.72	43.18	64	81.28	78.74
10	12.70	10.16	38	48.26	45.72	66	83.82	81.28
12	15.24	12.70	40	50.80	48.26	68	86.36	83.82
14	17.78	15.24	42	53.34	50.80	70	88.90	86.36
16	20.32	17.78	44	55.88	53.34	72	91.44	88.90
18	22.86	20.32	46	58.42	55.88	74	93.98	91.44
20	25.40	22.86	48	60.96	58.42	76	96.52	93.98
22	27.94	25.40	50	63.50	60.96	78	99.06	96.52
24	30.48	27.94	52	66.04	63.50	80	101.60	99.06
26	33.02	30.48	54	68.58	66.04			
28	35.56	33.02	56	71.12	68.58			

<b>ANYTEK</b>				<b>CUSTOMER COPY</b>			
ALL RIGHTS RESERVED. REPRODUCTION OR ISSUE TO THIRD PARTIES IN ANY FORM WHATSOEVER IS NOT PERMITTED WITHOUT WRITTEN AUTHORITY FROM THE PROPRIETOR. PROPERTY OF ANYTEK TECHNOLOGY CO., LTD							
TITLE		SB-Double row IC sockets Adapter pin10.0mmL Series					
PART NO.		SBXX10X00000G			DWG NO.		8SB0201
APPROVED		CHECKED	DESIGNED	DRAWN	CUST NO.		Tolerance
			Aaron	Aaron			X.    ±0.50
			2006.02.18	2006.02.18			X.X   ±0.30
							X.XX   ±0.10
							X*    ±1*
					SHEET: 01/01		REV.: C